

EC-CD14 CSP LED Strip

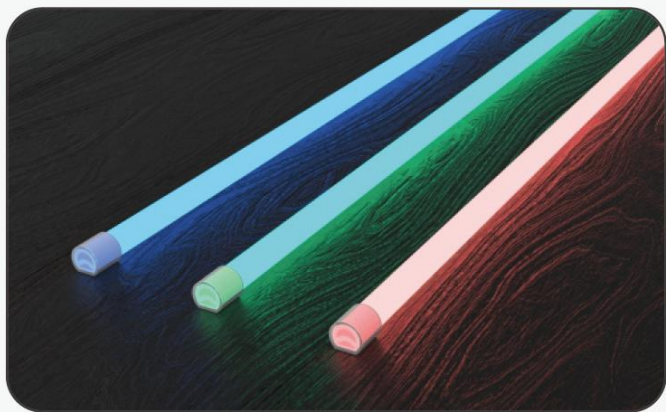

Application Environment:
Indoor
Outdoor

Description

LED strip lights for indoor or outdoor applications, such as under-cabinet lighting, coves, landscapes, vehicles, and more. Choose 24V or 12V LED tape lights of any color, brightness, or length, and install them using a range of compatible accessories

Features

- The appearance is simple and fashionable, and the decoration is strong;
- The luminescence is even and soft, showing the city's glamorous style;
- The electronic components are completely covered in silicone glue, and the insulation and water resistance can reach IP 66, which is safe to use;
- The silicone rubber lamp belt is soft and can be bent into different shapes at will, which is convenient to use;
- Widely used in decoration and lighting of buildings, bridges, roads, gardens, courtyards, floors, ceilings, furniture, cars, advertisements, signs, etc.

Basic Specifications

Color	2700K/3000K/4000K/5000K/ 6000K/Red light/green light/ice blue light
Working Voltage	DC24V
Max. Power Consumption	9W/1M
Light Source	240pcs LEDs/1M
Length	1m or 5m/roll
CRI	80
Control	ON/OFF
Source Life	50,000h
Diffuser	Silicone(Transparent, Opal,)
Weight	112g/meter

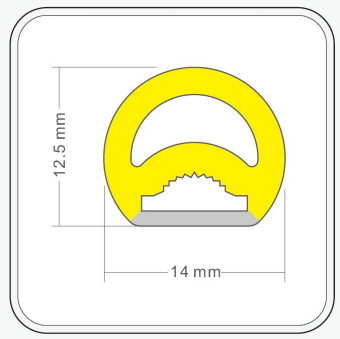
<p>Dimensions</p>	 <p>Production cross section</p>
<p>Installation</p>	<p>Clip</p>
<p>Working Temperature</p>	<p>-30°C to 50°C</p>
<p>Storage Temperature</p>	<p>-40°C to 70°C</p>
<p>Protection Rating</p>	<p>IP66</p>
<p>Beam Angle</p>	<p>270°</p>

Light Intensity Distribution



270° luminescence

Mounting Clip Accessories (Optional for choose)



Silicone tail plug



Straight-out plug



Translucent mounting buckle



Side plug (optional)

Step 1: Fix the transparent buckle in the installation position with screws.

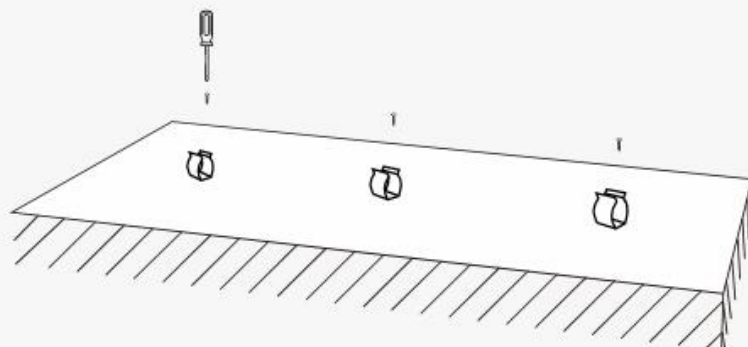

Step 2: Press the lamp belt into the transparent buckle in the left figure. The diagram after installation is as shown in the right figure.

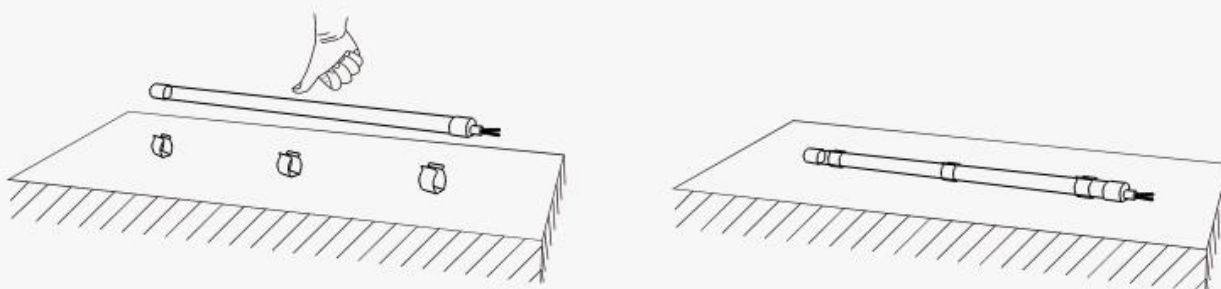

Installation Diagram

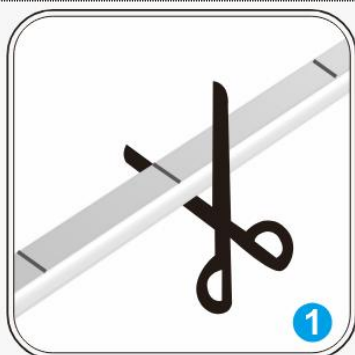

1 Cut at the position marked by the black strip on the back of the light strip. Do not cut between other positions to avoid damage to the light strip.



2 Schematic diagram after cutting.



3 Pass the wiring through the plug.

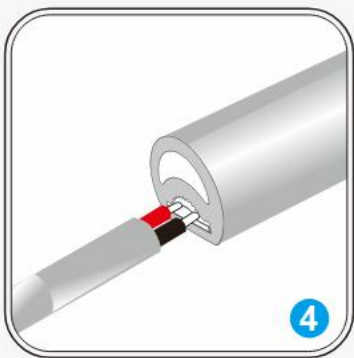

4

Press red positive and black negative to solder the wires on the bare board.

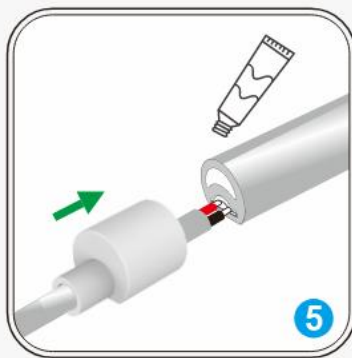

5

Apply glue to the port and cover the light bar with the plug in the direction.



6

Seal the outlet with glue in a circle to ensure that the plug is dry and installed firmly.



7

Follow the same steps to install the side-out plug.

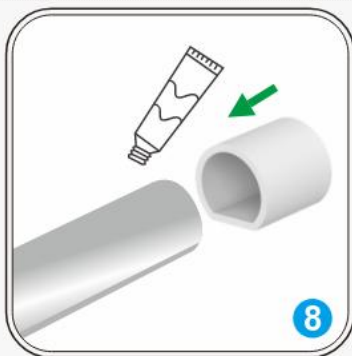

8

Prepare the tail plug, apply glue to the port, and cover the tail plug with the light bar according to the arrow.



9

The tail plug installation is complete.

Precautions

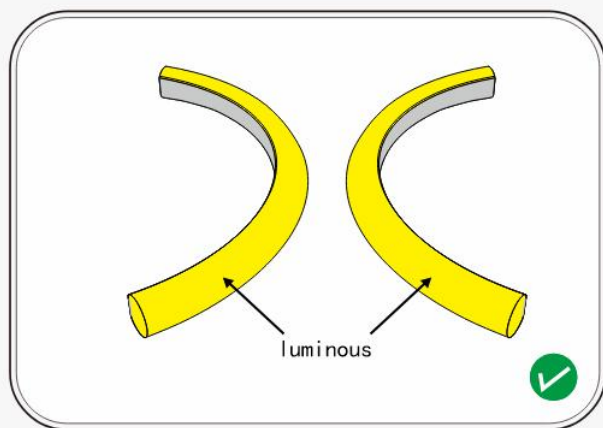

Correct bending method

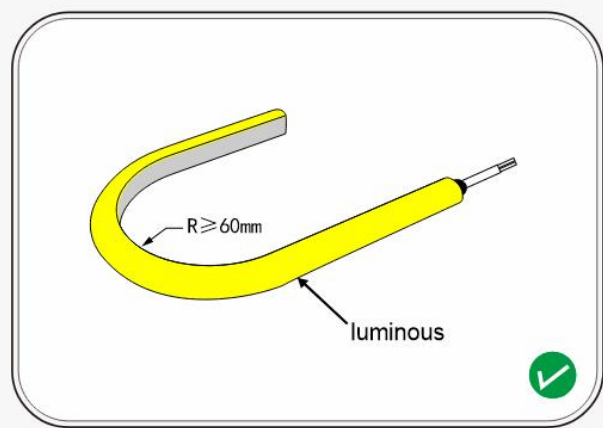

Minimum bending radius $R \geq 60\text{mm}$

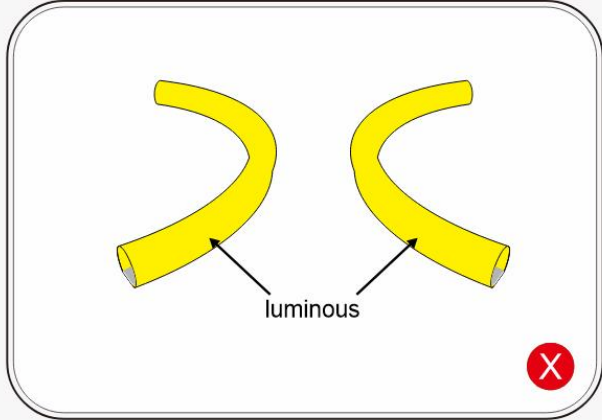

Wrong bending mode

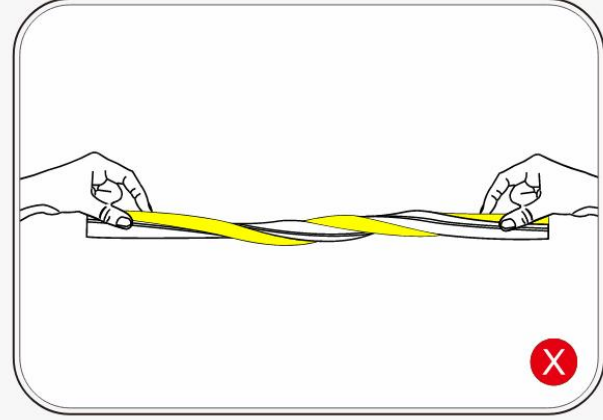

Do not twist and bend the light bar



- 1: This product is a low-voltage product and available for using AC - DC Switch power. Do not connect directly to AC 220V, otherwise it will burn the LED strip.
- 2: Please read the product specification in detail before using this product, and ask professionals to install it to ensure safe use.